



ACCESSORI  
ACCESSOIRES

Incandescenza  
*Incandescent*

Scarica  
*Discharge*

Alogiene a tensione di rete  
*Mains voltage halogen*

Alogiene a bassissima tensione  
*Very low voltage halogen*



Accessori  
*Accessoires*



Sezionatori  
*Switches*



**ACCESSORI  
ACCESSOIRES**

# ACCESSORI ACCESSOIRES

**ART. 030**

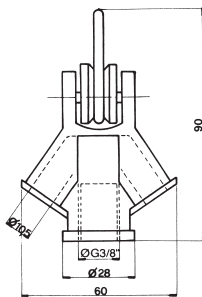

- Raccordo di sospensione a 2 vie
- Corpo in fusione di alluminio con filetto femmina da 3/8" G
  - Gancio in acciaio zincato
  - Carrucola in porcellana
  - Portata utile: 12 Kg
  - Peso: 74 gr.

*Two-way suspension connection*

- Die cast aluminium body with 3/8" G female thread
- Galvanized steel hook
- Porcelain pulley
- Useful capacity: 12 kg
- Weight: 74 gr.

**ART. 088**

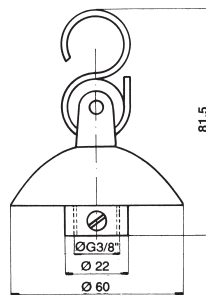

- Raccordo di sospensione ad ombrellino
- Corpo in alluminio pressofuso e verniciato nero
  - Raccordo con filetto femmina da 3/8" G e vite bloccaggio Tige
  - Gancio in acciaio zincato
  - Carrucola in porcellana
  - Portata utile: 12 Kg
  - Peso: 63gr.

**Art. 088/B**  
Stesso raccordo di sospensione ma con corpo non verniciato

*Suspension cap*

- Die-cast black painted aluminium body
- Connection with 3/8" G female thread and Tige blocking screw
- Galvanized steel hook
- Porcelain pulley
- Useful capacity: 12 kg
- Weight: 63 gr.

**Art. 088/B**  
Same suspension, body not painted

**ART. 088/I**

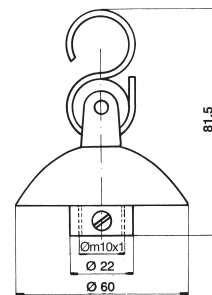

- Stessa sospensione ma con filetto femmina 10x1

*Same suspension with 10x1 female thread*

## ART. 0240

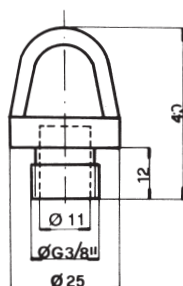

Gancio di sospensione cieco da 3/8" G  
 - Corpo in ottone pressofuso e nichelato con filetto maschio da 3/8" G  
 - Peso: 26 gr.

*3/8" G suspension hook with internal blind hole*  
 - Die-cast nickel-plated brass body with 3/8" G male thread  
 - Weight: 26 gr.

## ART. 0241

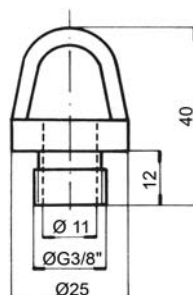

Gancio di sospensione con foro passante da 3/8" G  
 - Stesse caratteristiche dell'art. 0240 ma con foro passante  
 - Peso: 24 gr.

*3/8" G suspension hook with internal through hole*  
 - Same characteristics of the art. 0240 but with internal through hole  
 - Weight: 24 gr.

## ART. 0244

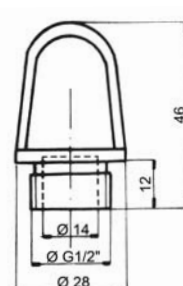

Gancio di sospensione cieco da 1/2" G  
 - Corpo in ottone pressofuso e nichelato con filetto maschio da 1/2" G  
 - Peso: 40 gr.

*1/2" G suspension hook with internal blind hole*  
 - Die-cast nickel-plated brass body with 1/2" G male thread  
 - Weight: 40 gr.

# ACCESSORI ACCESSOIRES

**ART. 0245**

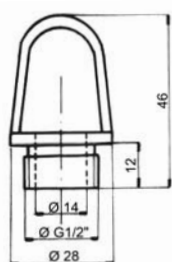

Gancio di sospensione con foro passante da 1/2" G  
- Stesse caratteristiche dell'art. 0244 ma con foro passante  
- Peso: 37 gr.

*1/2" G suspension hook with internal through hole*  
- Same characteristics of the art. 0244 but with internal through hole  
- Weight: 37 gr.

**ART. 0250**

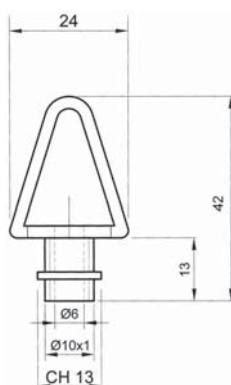

Gancio di sospensione con foro passante  
Corpo in ottone pressofuso con dadino  
- Peso gr.13

*Suspension hook with internal through hole*  
*Die-cast brass body with small nut*  
- Weight gr. 13

**ART. 0150**

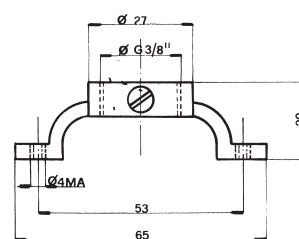

Raccordo da 3/8" per portalamпада  
- Corpo in alluminio pressofuso  
- Filetto femmina da 3/8" G e vite bloccaggio Tige  
- Peso: 18 gr.

**Art. 0150/A**  
Stesso raccordo ma con vite per messa a terra

*3/8 G jumper connection for lampholder*  
- Die-cast aluminium body  
- 3/8" G female thread with Tige locking screw  
- Weight: 18 gr.

**Art. 0150/A**  
*Same jumper connection with earth screw.*

## ART. 0151

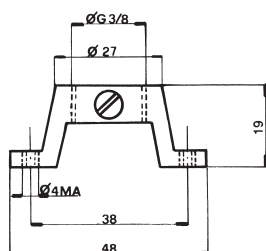

Raccordo da 3/8" per portalamпада  
 - Corpo in alluminio pressofuso  
 - Filetto femmina da 3/8" G e vite bloccaggio Tige  
 - Peso: 15 gr.

*3/8 G jumper connection for lampholder*  
 - Die-cast aluminium body  
 - 3/8" G female thread with Tige locking screw  
 - Weight: 15 gr.

## ART. 0152

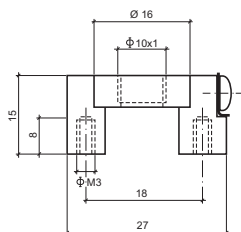

Raccordo 10x1 per portalamпада.  
 - Corpo in alluminio pressofuso  
 - Filetto femmina da 10x1 e vite di bloccaggio Tige  
 - Vite per messa a terra per fili 0,5 ÷ 2,5 mm<sup>2</sup>  
 - Peso: 10 gr.

**Art. 0152/B**  
 Stesso raccordo ma senza vite per messa a terra

*10x1 jumper connection*  
 - Die-cast aluminium body  
 - 10x1 female thread with Tige locking screw  
 - Earth screw for leads 0,5 ÷ 2,5 mm<sup>2</sup>  
 - Weight: 10 gr.

**Art. 0152/B**  
 Same jumper connection without earth screw

## ART. 0153

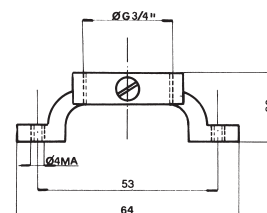

Raccordo da 3/4" per portalamпада  
 - Corpo in alluminio pressofuso  
 - Filetto femmina da 3/4" G e vite bloccaggio Tige  
 - Peso: 20 gr.

*3/4" G jumper connection for lampholder*  
 - Die-cast aluminium body  
 - 3/4" G female thread with Tige locking screw  
 - Weight: 20 gr.

# ACCESSORI ACCESSOIRES

**ART. 0238**

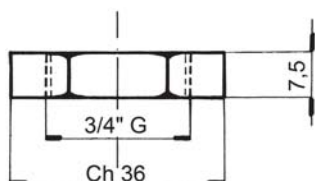

Dado da 3/4" G  
- Corpo in alluminio pressofuso  
- Peso: 12 gr.

*3/4" G Nut*  
- Die-cast aluminium body  
- Weight: 12 gr.

**ART. 0239**

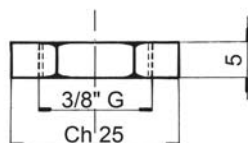

Dado da 3/8" G  
- Corpo in alluminio pressofuso  
- Peso: 5 gr.

*3/8" G Nut*  
- Die-cast aluminium body  
- Weight: 5 gr.

**ART. 0402:0413**

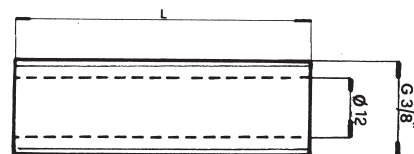

Raccordi 3/8" G in alluminio anticorodal  
*3/8" G aluminium anticorrosion connections*

Articolo Article	Lungh. Length mm.	Peso Weight gr.
0402	15	3,5
0404	30	7
0406	50	12
0408	70	16
0410	100	24
0411	120	27
0412	150	36
0413	200	48

ART. 0144-1

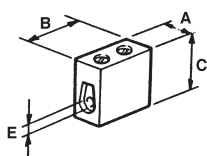

ART. 0144-2  
0143-2  
0142-2

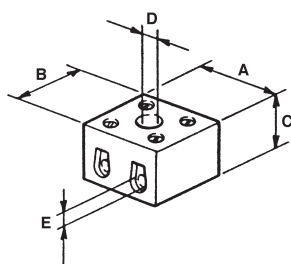

ART. 0144-3  
0143-3  
0142-3

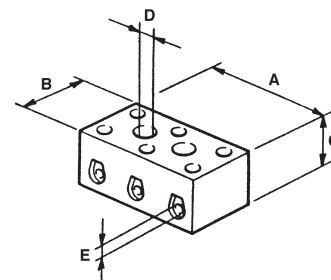

- Morsetti in porcellana  
- Corpo in porcellana  
- Morsetti a bussola in ottone grezzo  
- Viti in acciaio zincato  
- Tensione nominale: 400V  
- Temperatura di esercizio: 300°C

- Porcelain junction-box  
- Porcelain body  
- Rough brass connector terminals  
- Galvanized iron screws  
- Nominal Voltage: 400V  
- Working temperature: 300°C

Articolo Article	Poli Poles	Sez. Sect.	Corrente nom. Nominal Curr.	A	B	C	D	E	Peso Weight
	n°	mm <sup>2</sup>	Amp.	mm.	mm.	mm.	mm.	mm.	gr.
0142-2	2	16	32	30	32,5	23	4,5	6	46
0142-3	3	16	32	45	32,5	23	4,5	6	65
0143-2	2	6	16	24	26	20,5	4	4,2	24
0143-3	3	6	16	37	26	20,5	4	4,2	37
0144-1	1	4	10	10	25	18,5		3,1	9
0144-2	2	4	10	22	25	18,5	4	3,1	20
0144-3	3	4	10	34	25	18,5	4	3,1	28

Design by  
Telonius Whitehead  
2009





OMT S.R.L.  
Via Tito Speri 7/E  
25040 Nigoline di Cortefranca (BS)  
tel. 030984128 - 030984181  
fax 030984256  
info@omtsrl.com  
C.F./P. IVA 00219160173

[www.omtsrl.com](http://www.omtsrl.com)