

Attacco/Cap

E27

Per lampade a scarica
For discharge lamps

ART. 0109

Con alette esterne ad interasse di fissaggio 52 ÷ 53 mm.
With external vanes with centre distance from 52 ÷ 53 mm.

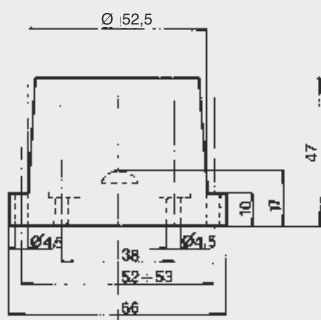

ART. 0109/SA

Senza alette esterne. Interasse di fissaggio 38 mm.
Without external vanes fixing wheelbase 38 mm.

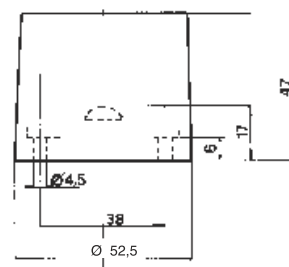

Dati tecnici

- Corpo in porcellana
- Virola in ottone pressofuso nichelato
- Contatti centrale e laterale in ottone nichelato
- Molla del contatto centrale in acciaio inox
- Morsetti a bussola in ottone nichelato idonei per fili 0,5 ÷ 2,5 mm²
- Tensione nominale: 500 V
- Corrente nominale: 4 A
- Tensione d'impulso max: 5 kV
- Temperatura max del portalamпада: 210°C
- Categoria di tenuta all'impulso: III
- Peso: 150 gr.

Technical data

- Porcelain body
- Bulb screw base made of die-cast, nickel-plated brass
- Nickel plated brass central and lateral contact
- Central contact spring made of stainless steel
- Connector terminals made of nickel-plated brass, suitable for leads 0,5 ÷ 2,5 mm²
- Nominal voltage: 500 V
- Nominal current: 4 A
- Max rated pulse voltage 5 kV
- Max temperature of lampholder: 210°C
- Impulse withstand category: III
- Weight: 150 gr.



ART. 0109/N

ART. 0109/SN

ART. 0109/P

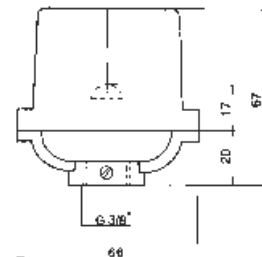
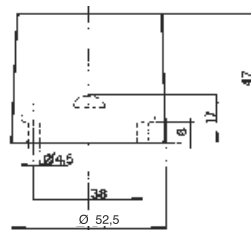
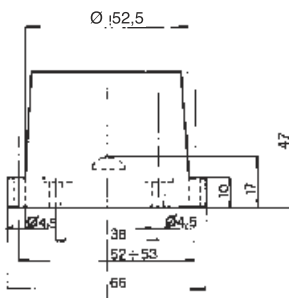

Come art. 0109 ma con contatti speciali in cupronichel, indicato per atmosfere particolarmente corrosive.

As art 0109, but supplied with special contacts made of copper-nickel, suitable for particullary corrosive atmosphere.

Come art. 0109/SA ma con contatti speciali in cupronichel, indicato per atmosfere particolarmente corrosive.

As art 0109/SA, but supplied with special contacts made of copper-nickel, suitable for particullary corrosive atmosphere.

Portalamпада assembled con raccordo in alluminio pressofuso (ns. art. 0150). Filetto femmina da 3/8" G con vite di bloccaggio Tige.

Peso: 175 gr.

Art. 0109/P3

Come art. 0109/P ma con raccordo completo di vite per messa a terra idonea per fili 0,5 ÷ 2,5 mm²

Lampholder assembled with die-cast aluminium jumper connection (our art. 0150). 3/8" G female thread with Tige locking screw.

Weight: 175 gr.

Art. 0109/P3

As art. 0109/P, but supplied with jumper connection complete with earthing screw for leads 0,5 ÷ 2,5 mm²

Attacco/Cap

E27

Per lampade a scarica
For discharge lamps

ART. 0109/P1

ART. 0109/P2

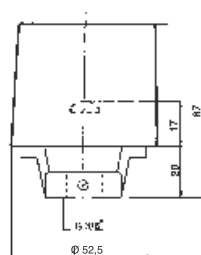
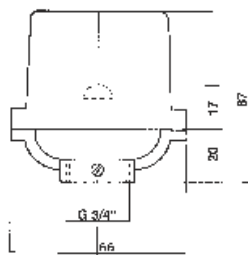

Portalamпада assembled with raccordo in alluminio pressofuso (ns. art. 0153). Filetto femmina da 3/4" G con vite di bloccaggio Tige. Peso: 177 gr.

Lampholder assembled with die-cast aluminium jumper connection (our art. 0153). 3/4" G female thread da with Tige locking screw. Weight: 177 gr.

Portalamпада senza alette assembled con raccordo in alluminio pressofuso (ns. art. 0151). Filetto femmina da 3/8" G con vite di bloccaggio Tige. Peso: 165 gr.

Lampholder assembled with die-cast aluminium jumper connection (our art. 0151). 3/8" G female thread with Tige locking screw. Weight: 165 gr.