

Attacco/Cap

G4 · GZ4 · G5,3 · GX5,3
G6,35 · GX6,35 · GY6,35
GZ6,35



Per lampade ad incandescenza ad alogeni a bassissima tensione
For very low voltage halogen incandescent lamps

ART. 022

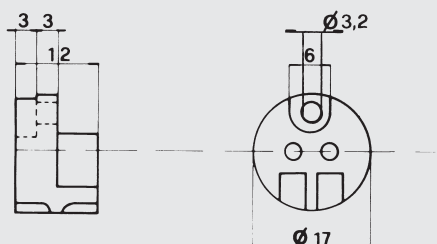

Dati tecnici

- Corpo in steatite
- Morsetti a bussola in ottone nichelato per fissaggio lampada
- Morsetti serrafile a bussola in ottone nichelato idonei per sezioni $0,5 \div 2,5 \text{ mm}^2$
- Tensione nominale: 24V
- Corrente nominale: 10A
- Temperatura max del connettore: 350°C
- Peso: 6 gr.

Technical data

- Steatite body
- Nickel-plated brass bushing for fixing the lamp
- Clamp terminals made of nickel-plated brass suitable for leads $0,5 \div 2,5 \text{ mm}^2$
- Nominal voltage: 24V
- Nominal current: 10A
- Max nominal working temperature: 350°C
- Weight: 6 gr.