

ART. 0154

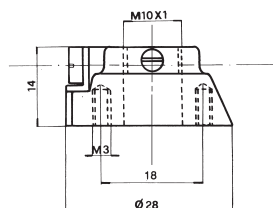

Raccordo in alluminio pressofuso conico. Filetto femmina da 10x1 con vite di bloccaggio Tige. Vite per messa a terra per fili $0,5 \div 2,5 \text{ mm}^2$.
Peso: 10 gr.

*Conical connection made of die-cast aluminium. 10x1 female thread with Tige locking screw. Earth screw for leads from $0.5 \div 2.5 \text{ mm}^2$.
Weight: 10 gr.*

ART. 0203

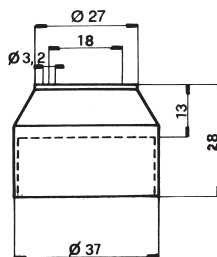

Cappuccio in materiale termoplastico per doppio isolamento completo di piastrina per isolamento vite M3.

Art. 0203/A

Su richiesta con filetto femmina da 10x1.
Peso: 11 gr.

Thermoplastic cap for double insulation complet with plate for i M3 nsulation screw.

Art. 0203/A

*Available with 10x1 female thread on request
Weight: 11 gr.*