

ART. 0151

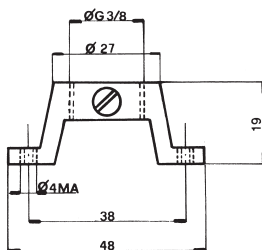

Raccordo da 3/8" per portalamпада
 - Corpo in alluminio pressofuso
 - Filetto femmina da 3/8" G e vite bloccaggio Tige
 - Peso: 15 gr.

3/8 G jumper connection for lampholder
 - Die-cast aluminium body
 - 3/8" G female thread with Tige locking screw
 - Weight: 15 gr.

ART. 0152

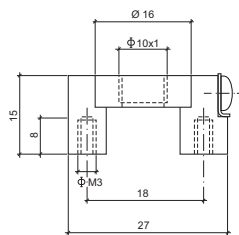

Raccordo 10x1 per portalamпада.
 - Corpo in alluminio pressofuso
 - Filetto femmina da 10x1 e vite di bloccaggio Tige
 - Vite per messa a terra per fili 0,5 ÷ 2,5 mm²

- Peso: 10 gr.
Art. 0152/B
 Stesso raccordo ma senza vite per messa a terra

10x1 jumper connection
 - Die-cast aluminium body
 - 10x1 female thread with Tige locking screw
 - Earth screw for leads 0,5 ÷ 2,5 mm²
 - Weight: 10 gr.

Art. 0152/B
 Same jumper connection without earth screw

ART. 0153

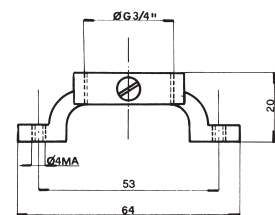

Raccordo da 3/4" per portalamпада
 - Corpo in alluminio pressofuso
 - Filetto femmina da 3/4" G e vite bloccaggio Tige
 - Peso: 20 gr.

3/4" G jumper connection for lampholder
 - Die-cast aluminium body
 - 3/4" G female thread with Tige locking screw
 - Weight: 20 gr.